

Max. Druck	3,0 MPa
Temp.	-195 °C - 225°C
Plattenmaterial	AISI 304, Werstoff-Nr: 1.4301
Fläche pro Platte	0,052 m ²
Fläche	A= (n-2) * 0,052 m ²
Lot	99,9 % Cu
	F1 → F3; F4 → F2

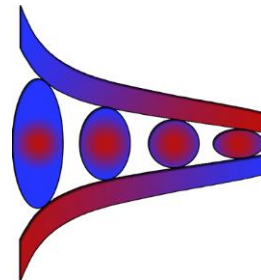

EWT-B3-52
G1" / Ver 1

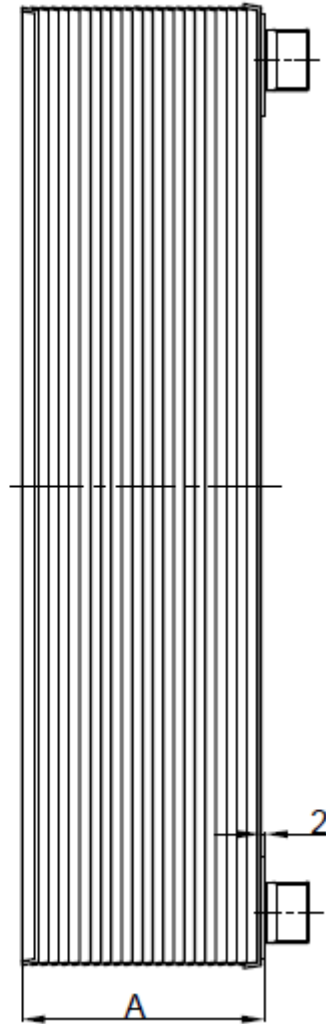
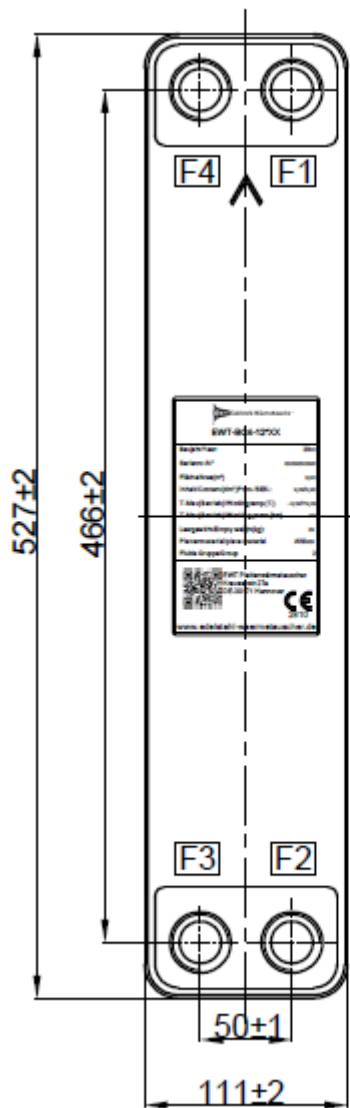

G1" Connection(L014)

F1 F2 F3 F4

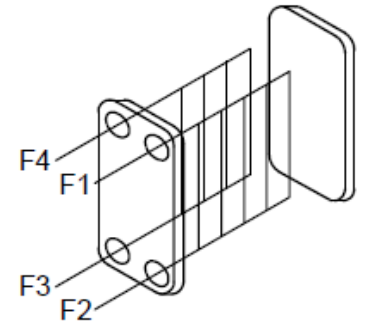
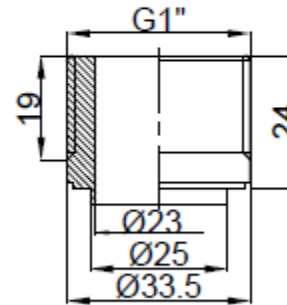

Max. Druck	3,0 MPa
Temp.	-196 °C - 200°C
Plattenmaterial	AISI 304, Werstoff-Nr: 1.4301
Fläche pro Platte	0,052 m ²
Fläche	A= (n-2) * 0,052 m ²
Lot	99,9 % Cu
	F4 → F; F2 → F1

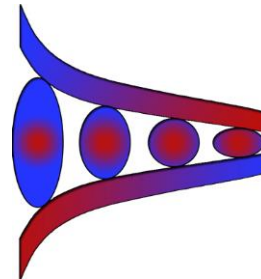

EWT-B3-52
G1" / Ver 2

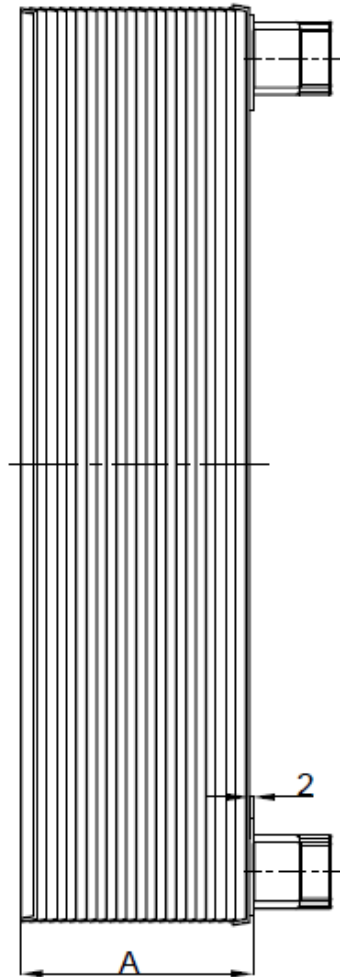
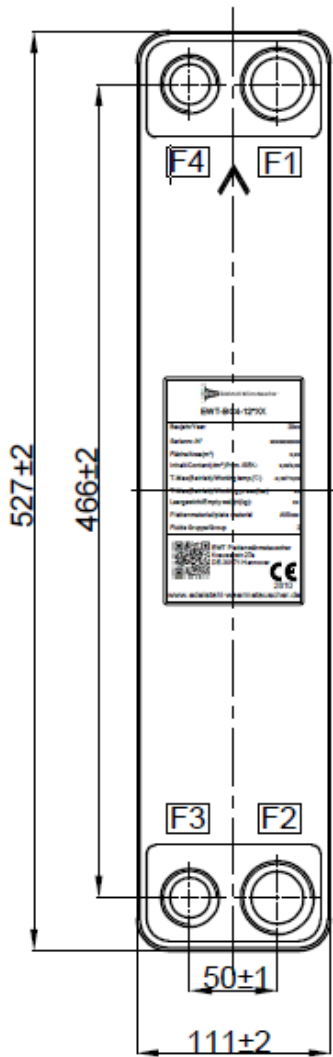

G1"1/4E Connection(L240C)

F1 F2

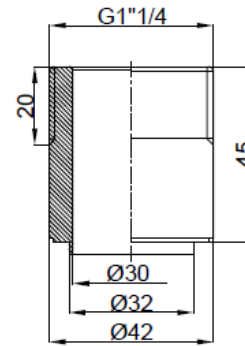

G1"R Connection(L014R-3)

F3 F4

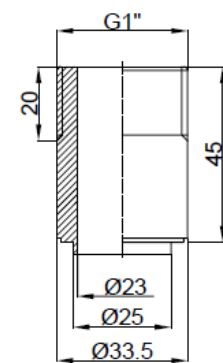

Max. Druck	3,0 MPa
Temp.	-196 °C - 200°C
Plattenmaterial	AISI 316L, Werstoff-Nr: 1.4401
Fläche pro Platte	0,052 m ²
Fläche	A= (n-2) * 0,052 m ²
Lot	99,9 % Cu
	F4 → F3; F2 → F1

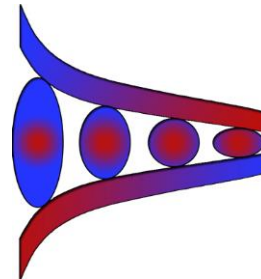

EWT-B3-52
2x G 1" / 2x G 5/4"